

128 Bed Minimum Security Dorm
Charleston County, South Carolina



Challenge: Due to severe overcrowding additional bed space was needed quickly. In addition the available site was constrained by existing site conditions: a fence at the property line on the North end of the site, by an existing structure on the South, by a fence and roadway on the East and by another existing structure on the West, making access very difficult and Public Utilities needed to be relocated to use the site.

Modular Solution: After determining the available footprint, a single story structure comprised of 16 modular units, (15,000 sq. ft.), was designed to fit the available space. The new structure was connected to an existing structure with a covered/fenced walkway. The facility has a backup generator capable of supplying all electrical needs for 3 days without refueling. Also CCTV, PA/Intercom, IRT Man down, Electronic door controls, electronic lighting controls and Video Visitation were incorporated. Connection to the existing Central Security Control System was provided along with key features being controlled via a touch pad PC. An existing public sanitary sewer was relocated to accommodate the new structure.

1-877-GET-VMBS • www.vanguardmodular.com
1-877-349-9714 • www.schiavileasingcorp.com

Modular Solutions

Floor Plan for: 128 Bed Minimum Security Dorm

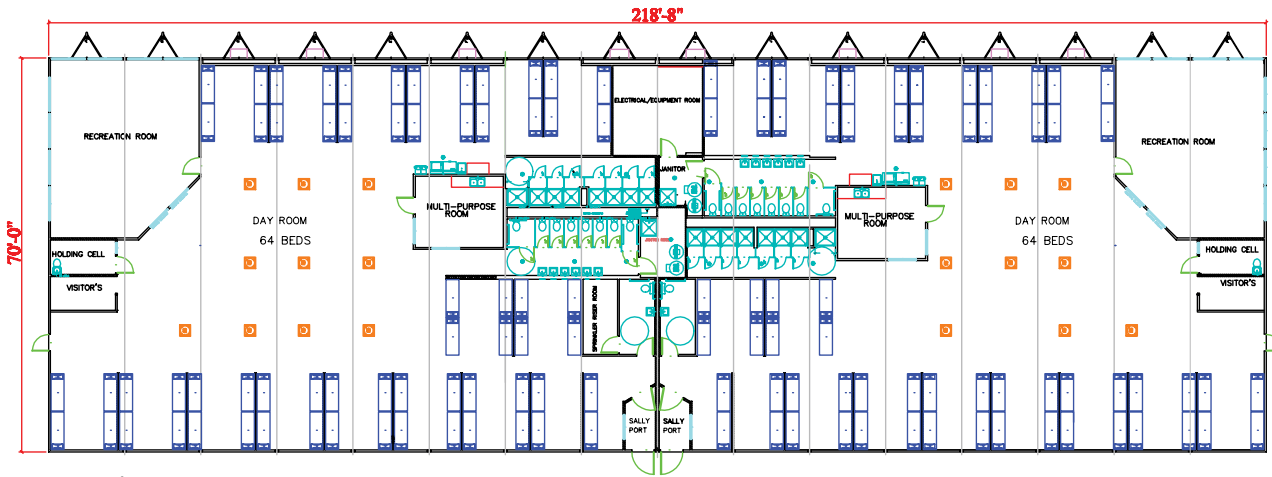

128 Bed Minimum Security Dorm
15,330 sq. ft.

Project Schedule

Notice of Award	May 15
Notice to Proceed.....	June 4
Engineering/Drawings	June 4 10 Aug 15
Permitting.....	July 5
Site work Starts.....	July 18
Foundation Starts	Aug 20
Deliver Modular Building	Sept 12
Set Modular Building	Sept 21
Trim out of Modulars.....	Sept to Dec
Utility Hookups.....	Sept to Dec
Substantial Completion.....	Dec 28
Occupancy	Jan 5
Start to Finish.....	235 Days



Corporate Headquarters
Valleybrooke Corporate Center
100 Lindenwood Drive, Suite 200 • Malvern, PA 19355
800-448-6772 • www.vanguardmodular.com



Schiavi Leasing Corporation
102 Industrial Drive • Oxford, ME 04270
877-349-9714 • www.schiavileasingcorp.com