

## HIGHLIGHTS

- 1,882 sq. ft.
- 2 Lg. Modular Classrooms
- Opt. Restrooms
- Closets and more

## LARGE CLASSROOM FLOOR PLAN/DOUBLEWIDE

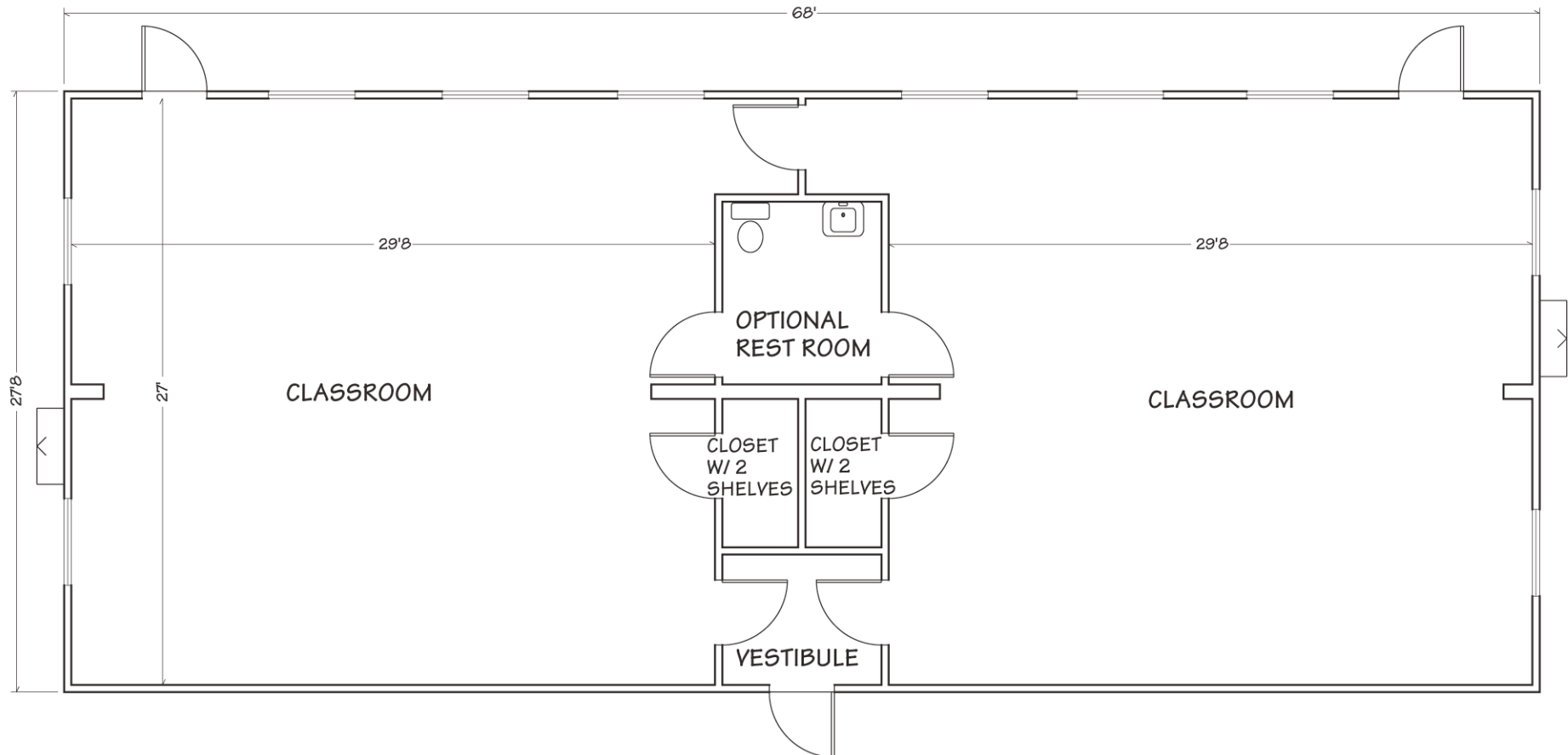

Corporate Headquarters  
Valleybrooke Corporate Center

100 Lindenwood Drive, Suite 200 • Malvern, PA 19355

703-349-6551 • [www.vanguardmodular.com](http://www.vanguardmodular.com) • [govbiz@vanguardmodular.com](mailto:govbiz@vanguardmodular.com)

APPROVED CONTRACTOR  
GSA # **GS-07F-5690R**

OTHER SIZES AND  
FLOOR PLANS  
AVAILABLE

### GENERAL SPECIFICATIONS

- Meet or exceed local building codes
- Suitable for temporary or permanent use
- Customize this building to meet your space requirements